

BR 710 4XX

Connection hose for eye showers & hand-held eye showers

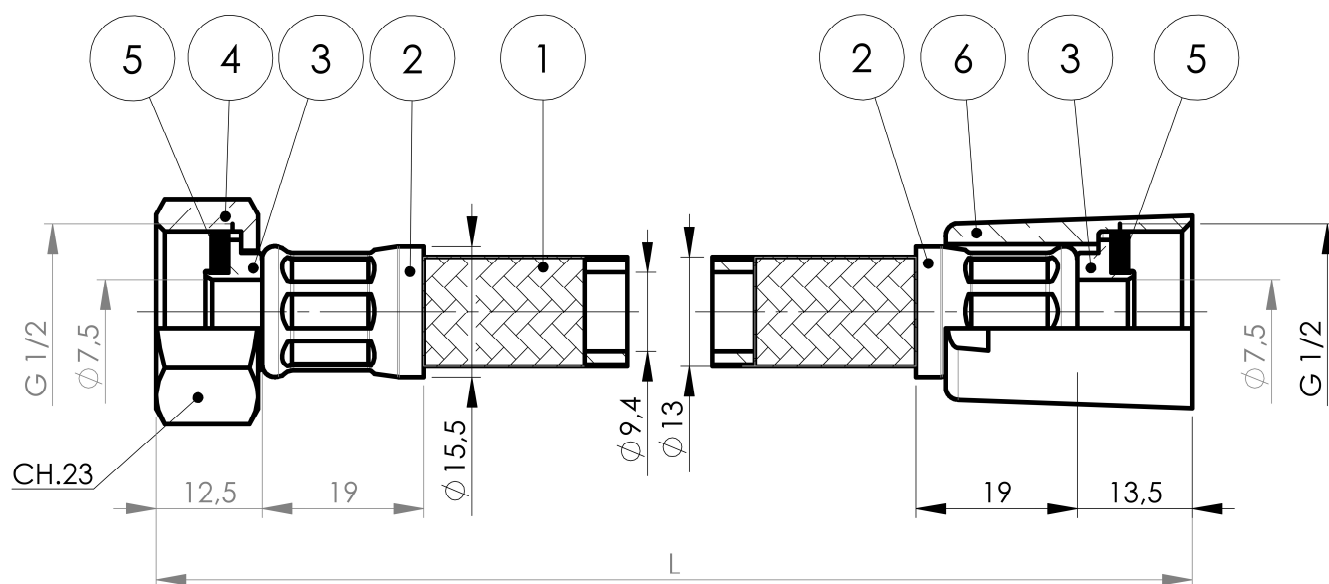
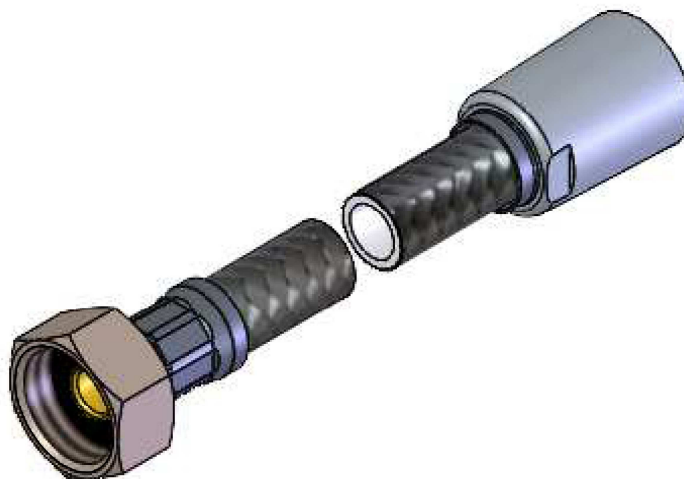

Technical description

Connection hose for eye showers and hand-held eye showers
 Stainless steel coated hose as connection hose for eye showers and hand-held eye showers, DIN-DVGW tested and approved.
 - Water inlet: 1/2" male
 - Water outlet: 1/2" female
 Manufacturer: B-SAFETY or equal
 Article-No.: BR 710 4XX

Technical specifications

Nominal size:	DN 8
Pressure stage:	PN 10
Operating pressure:	10 bar
Medium temperature:	max. 70°C
Water inlet:	1/2" female union nut
Water outlet eye shower:	1/2" female conical

Material-overview		Material	Material description
No. 1	Sheathing:	stainless steel	AISI 304
No. 1	Hose:	TPSIV	-
No. 2	Muffles (2x):	stainless steel	AISI 304
No. 3	Connection pieces (2x):	brass	CW617N
No. 4	Union nut:	brass	CW617N
No. 5	Seals (2x):	EPDM	-
No. 6	Conical:	brass	CW614N

Product overview

BR 710 410	Connection hose for eye showers and hand-held eye showers, length 1000 mm
BR 710 415	Connection hose for eye showers and hand-held eye showers, length 1500 mm
BR 710 420	Connection hose for eye showers and hand-held eye showers, length 2000 mm
BR 710 430	Connection hose for eye showers and hand-held eye showers, length 3000 mm
BR 710 475	Connection hose for eye showers and hand-held eye showers, length 1500 mm. With an additional transparent PVC sheath for easy cleaning.